

КРАТКОЕ ОПИСАНИЕ

Броневого Пушечно-Пулеметного
Автомобиля



ОБОРУДОВАННАГО ПУТИЛОВСКИМЪ
ЗАВОДОМЪ.

Масштабъ 1 к 35

ПЕТРОГРАДЪ.
Типографія „Двигатель“. Казначейская, 6
1915

GARFORD-PUTILOV ARMoured CAR

The Garford-Putilov armored car was a unique design among World War I armored cars with its 76.2mm cannon mounted in a rear turret and machine guns providing supplemental armament.

At the beginning of World War I, the Russian Empire had one of the most mechanized militaries in the world. However, domestic trucks weren't available in the necessary numbers, and companies capable of building them were busy with other vehicles, such as the Russo-Balt armored car, so American truck chassis built by Garford were imported. The Putilov Works – one of the largest metallurgical and machine-building companies in Europe – constructed the armored superstructure and mounted the weapons once the 3- and 4-ton Garford trucks were transported to Petrograd from Ohio via Arkhangelsk.

On Nov. 25, 1914, the order was placed for 30 Garford trucks to be mounted with a 76.2mm cannon and three machine guns. Development and construction delays meant the first Garford to see combat did so on June 24, 1915, but the full order for 30 wasn't completed until October of that year.

The cannon was mounted on a pedestal at the rear of the vehicle, and had a 280-degree field of fire. It couldn't fire straight ahead, and a rear driver position was included in the design to aid with movement and sighting.

During the Garford's first combat action, it helped repel a German assault on Russian lines by driving along a road and using its cannon as mobile artillery to surprise the attacking enemies. The weight of the Garford was one of its drawbacks compared with its contemporaries, but when it could travel on a road or hard ground, it delivered superior firepower that was found to be decisive again and again.

A naval version of the Garford armored car was also developed, used in the Peter the Great Fortress. The inspiration was to provide coastal defense that would be mobile as well as significantly cheaper than fixed coastal defense turrets in "disappearing" installations.

Eighteen were built, bringing the total number of Garford-Putilov armored cars built to 48. There were some differences between the naval and army variants, with some naval versions being built on 5-ton chassis and having a longer wheelbase and reinforced wheels. Naval Garfords arrived in July 1916, and while records are unclear, it's known that some saw action near Riga in August 1917.

During the Russian Civil War, Garford armored cars were used by many of the warring factions, seeing service on all sides, and later being absorbed into other military formations. It's known that Garfords served under the following flags: Russian Empire, Soviet Union, Ukraine, Latvia, Freikorps, Poland, Estonia, Romania and even the German Empire, which operated captured vehicles.

Text by Stanislav Kirilets, images from the author's personal archive.



"Dobrynia" - the first Garford to receive its baptism of fire.



A Garford from the 3rd platoon of the KoKampf department, numbered 109. The abbreviation K.d.P. probably meant "Command of the armoured car" (Kommando des Panzerwagens), and the abbreviation Abt. Stands for Abteilung (Detachment). The registration number MKIII 02452 indicates the 3rd Platoon Military Vehicle (Militär-Kraftfahrzeug III). Berlin, 1919.

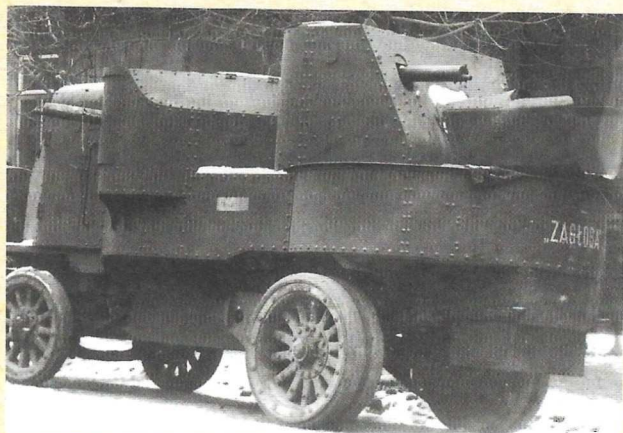

The Zagloba, Garford in Polish service, captured from the Red Army. 1920



Garford from the 35th Machine Gun Car Platoon in Tehran. Skulls with bones are painted on the sides and the hood of the car. 1916.



Kurzemnieks was the first Garford belonging to the Latvian Armed Forces. The vehicle has the name and identification marks in the colours of the Latvian flag. Riga, 1919.

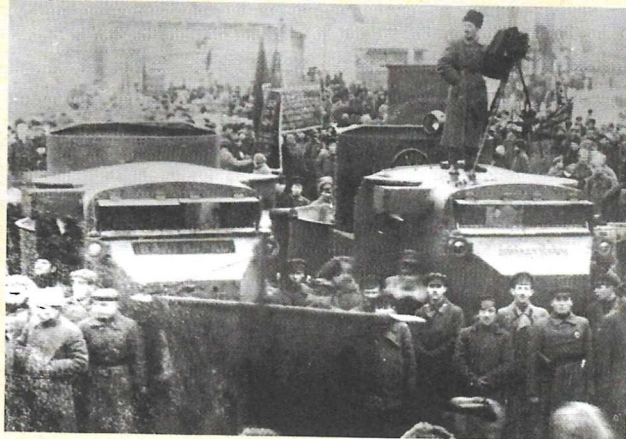

A festive demonstration on the occasion of the anniversary of the October Revolution. The names of "Karl Marx" and "Proletarian" are applied on the Garford armoured vehicles. Perm, November 1918.

Important Notes

- Read the instructions carefully before starting the assembly.
- Use glue intended for plastic models.
- Choking hazard. Keep small parts and plastic bags away from children.
- Always wear protective eyewear when cutting and a protective mask when painting, glueing and sanding.
- Use paints designed and suitable for plastic model kits.

Symbols Reference

	No Glue		Apply Decal
	Other Side		Option
	Cut/Remove		Drill

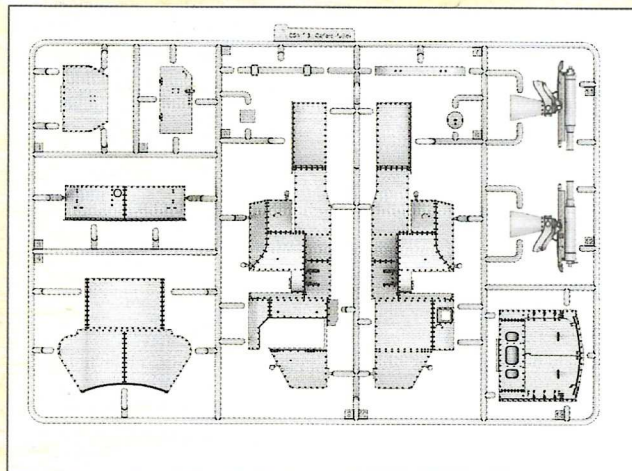

Fig. 1. Runner A

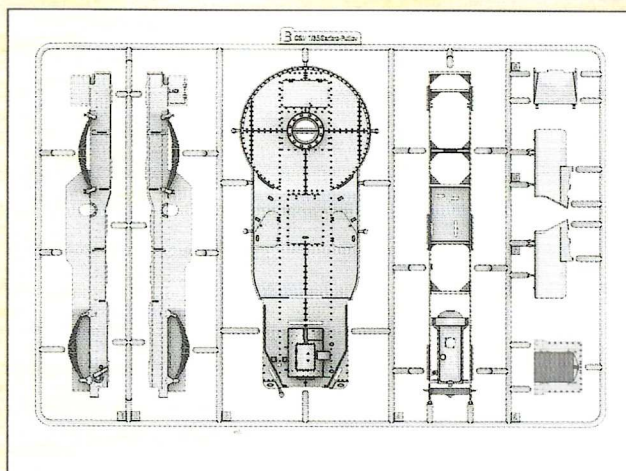

Fig. 2. Runner B

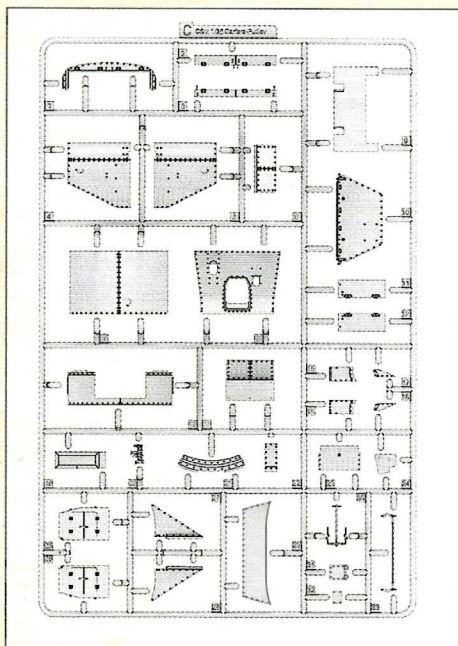

Fig. 3. Runner C

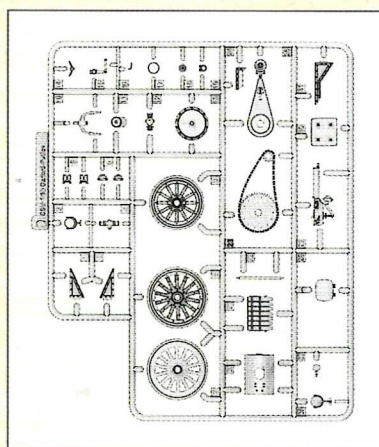

Fig. 4. Runner D, x2

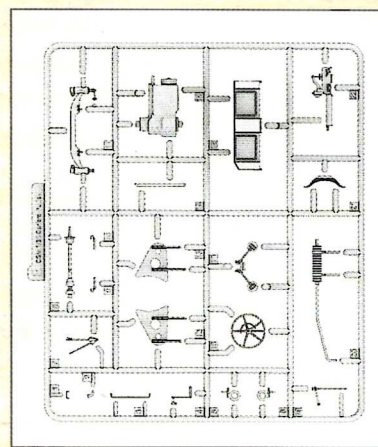

Fig. 5. Runner E

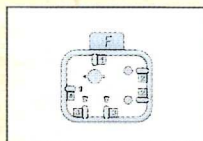

Fig. 6. Runner F

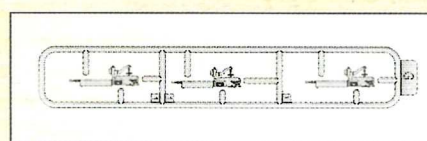
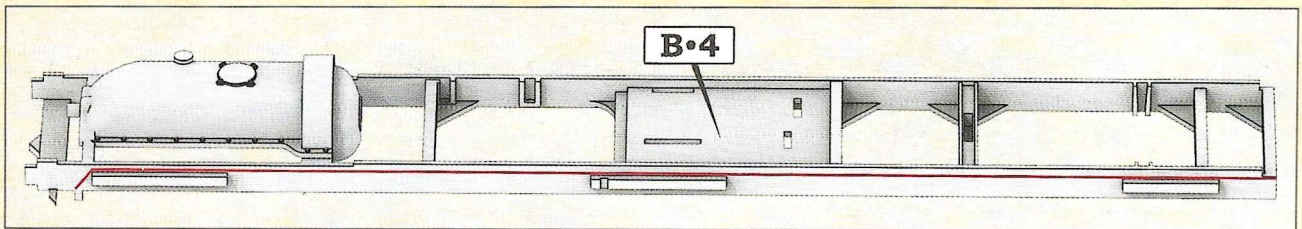
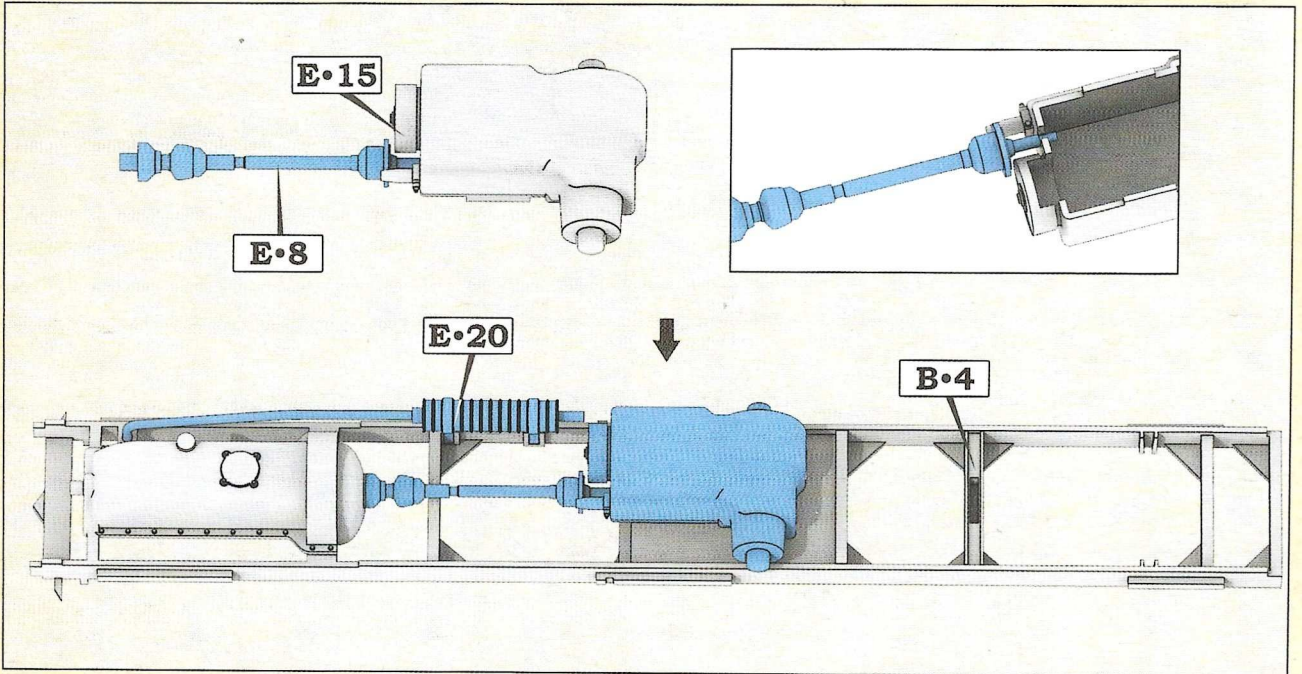

Fig. 7. Runner G, only for Freikorps version, kit number 350014

Decals are included with the kit, see additional markings instruction



Step 1. Sand down the mould line for better fitting of the side armour plates



Step 2. Assembling and installing the gearbox and the muffler

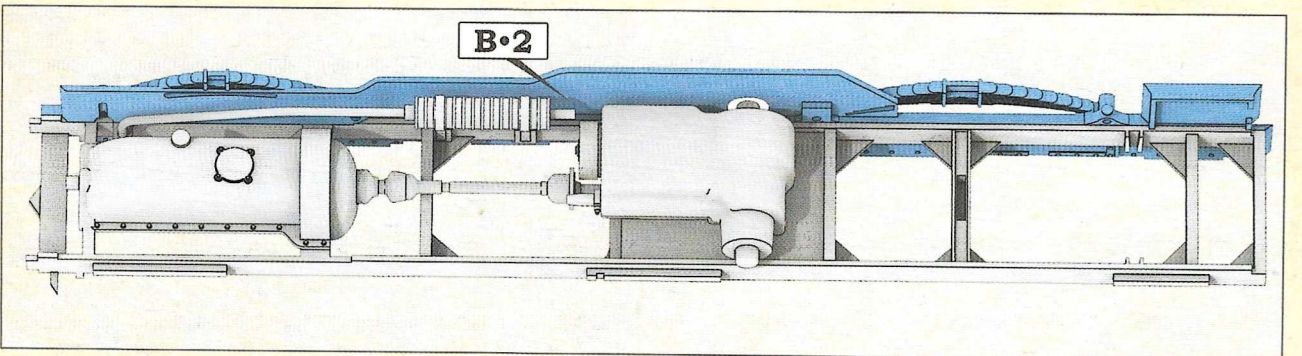

Step 3. Installing the side rails with side armour protection

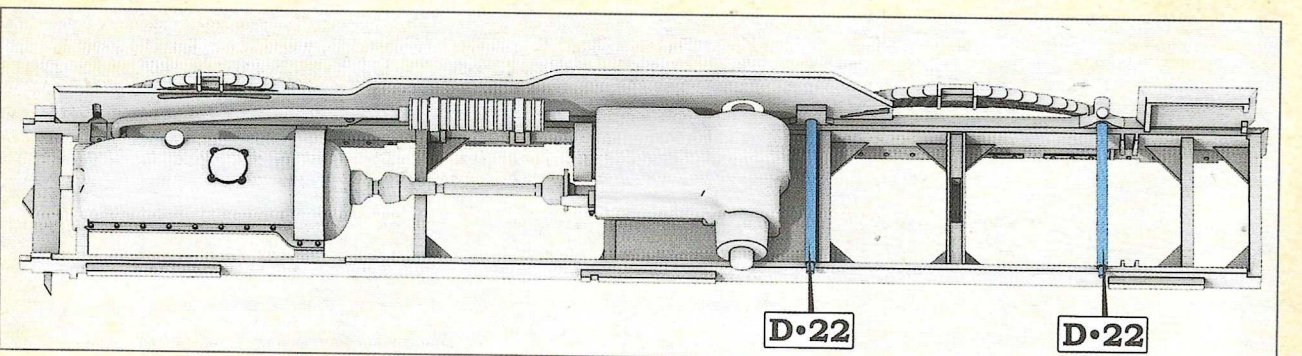

Step 4. Installation of the cross tubes

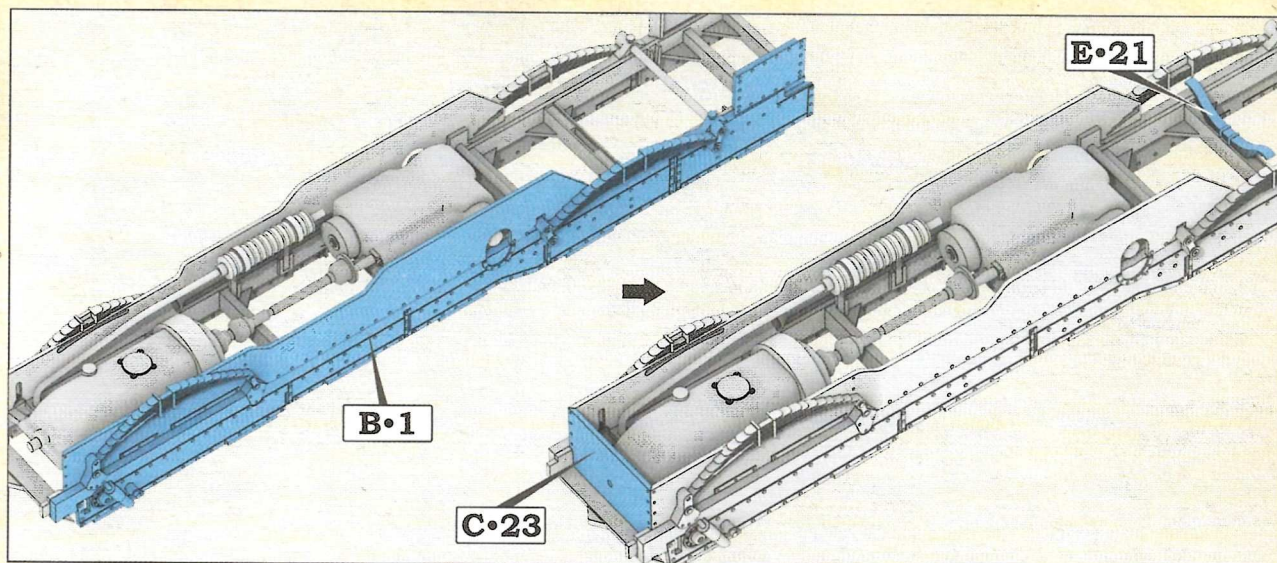

Step 5. Installing the front, side armour protection and the transverse leaf spring

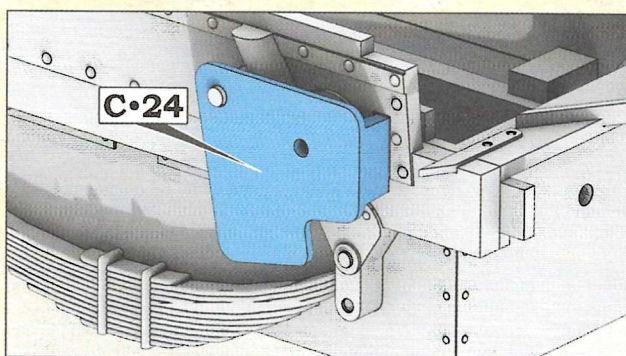

Step 6. Installing the steering box protection

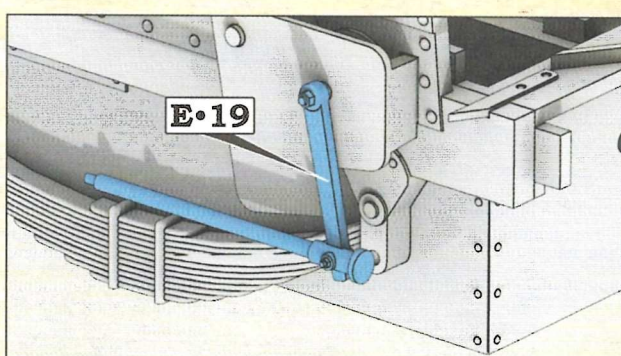

Step 7. Installing the steering drop arm. Check step 19

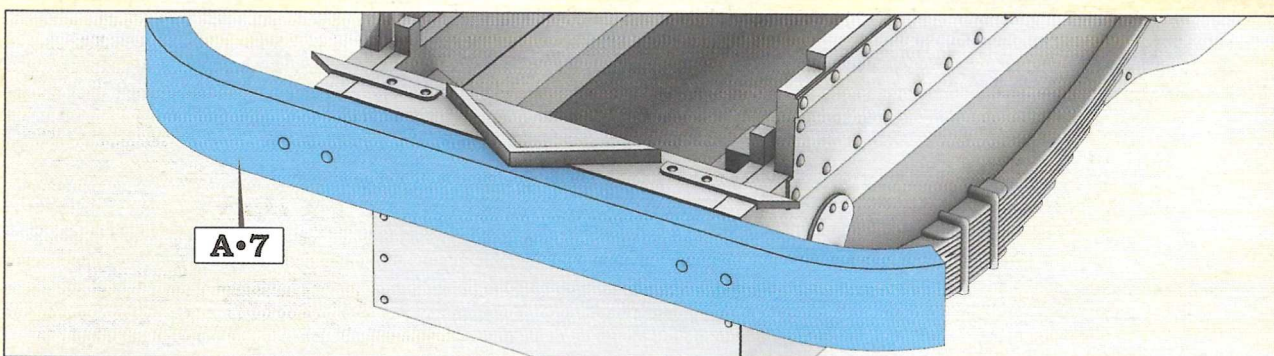

Step 8. Installing the front bumper

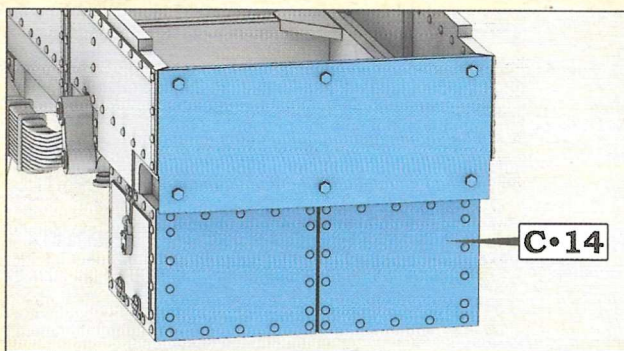

Step 9. Installing the rear armour protection

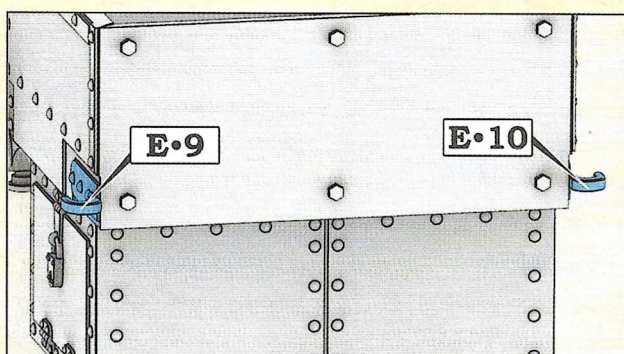

Step 10. Installing the rear tow hooks

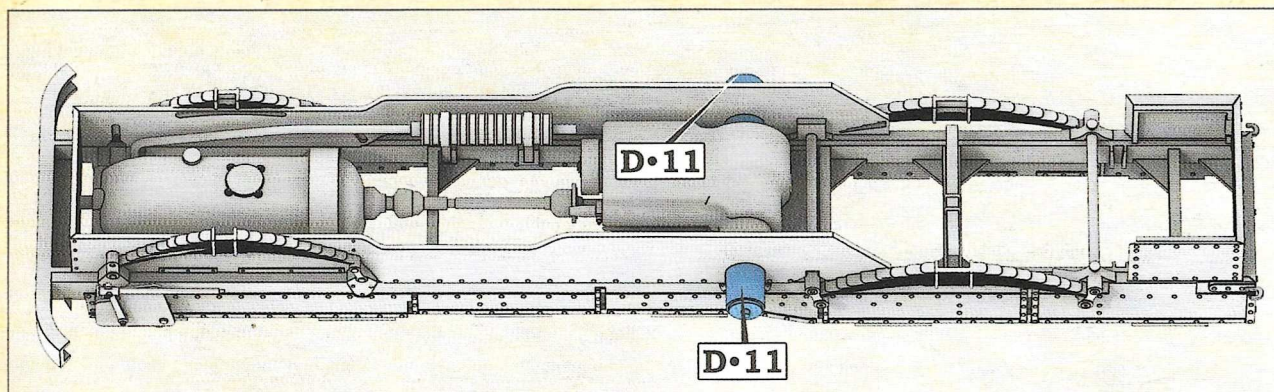

Step 11. Installing the chain drive mounts

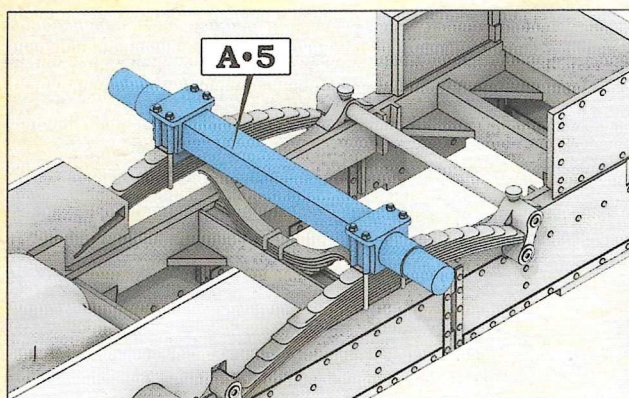

Step 12. assembling rear axle

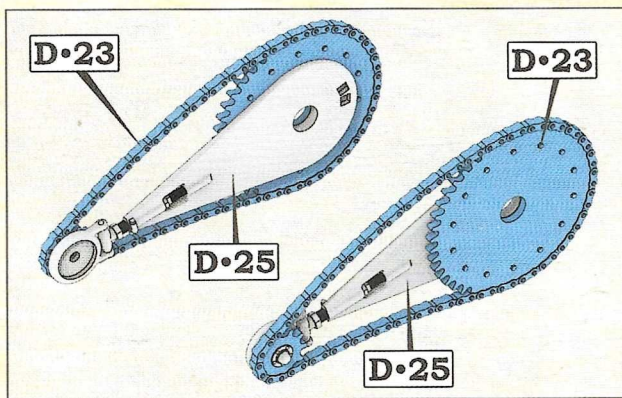

Step 13. Assembling the chain drive

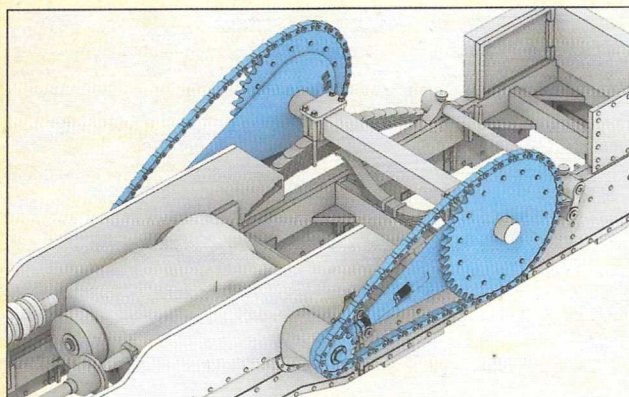

Step 14. Installing the chain drive

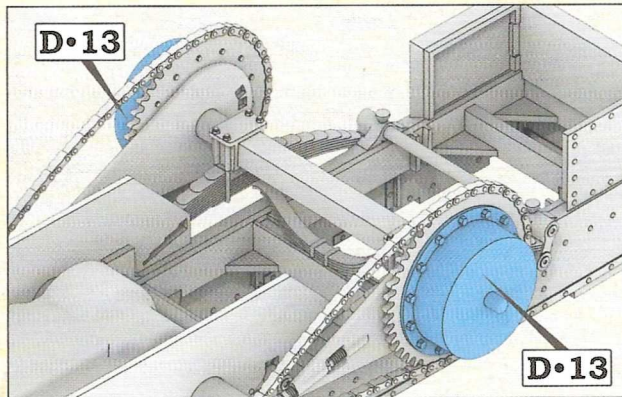

Step 15. Installation of the brake drums

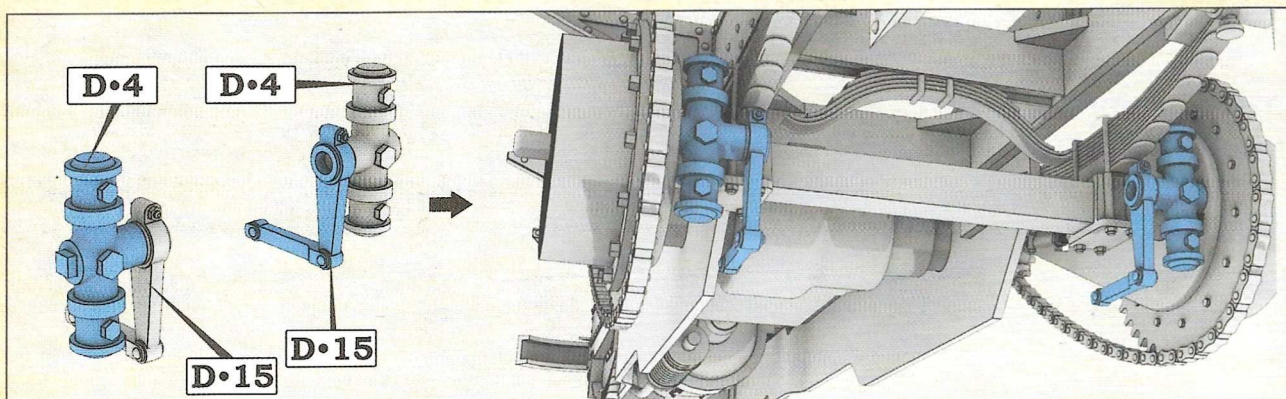

Step 16. Assembling and installing the foot brake actuators.

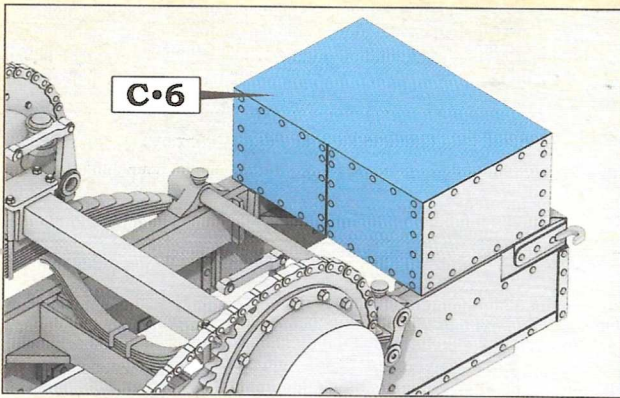

Step 17. Closing the rear stowage box

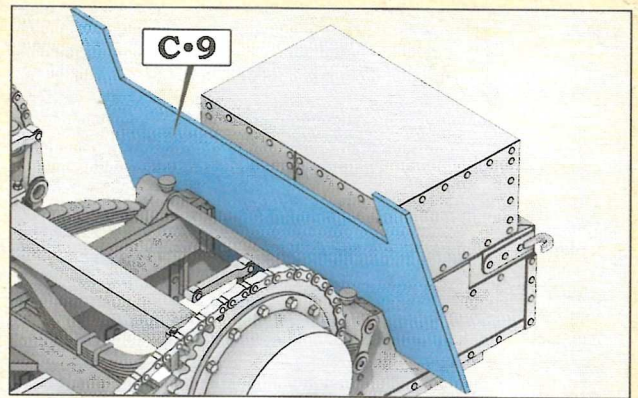

Step 18. Installing the chain drive protection

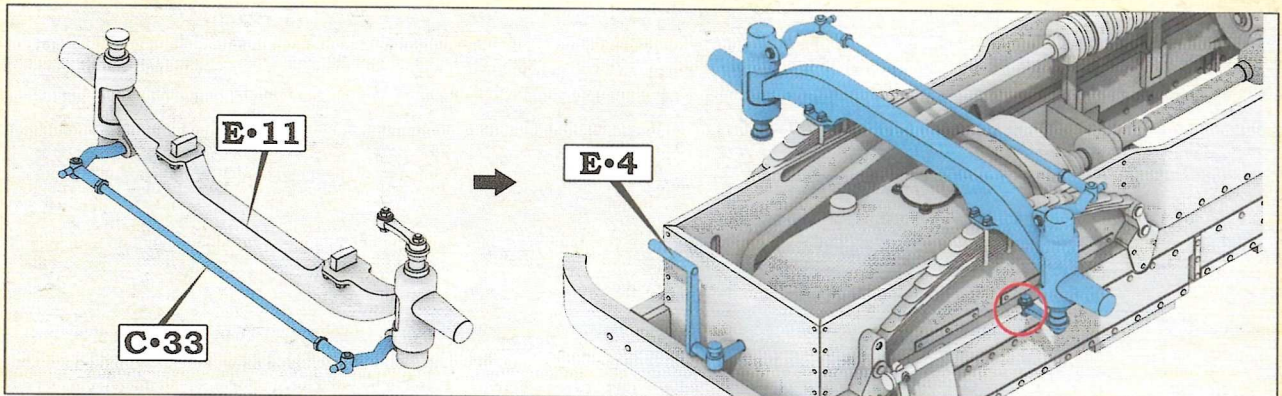

Step 19. Assembling and installation of the front axle and hand crank

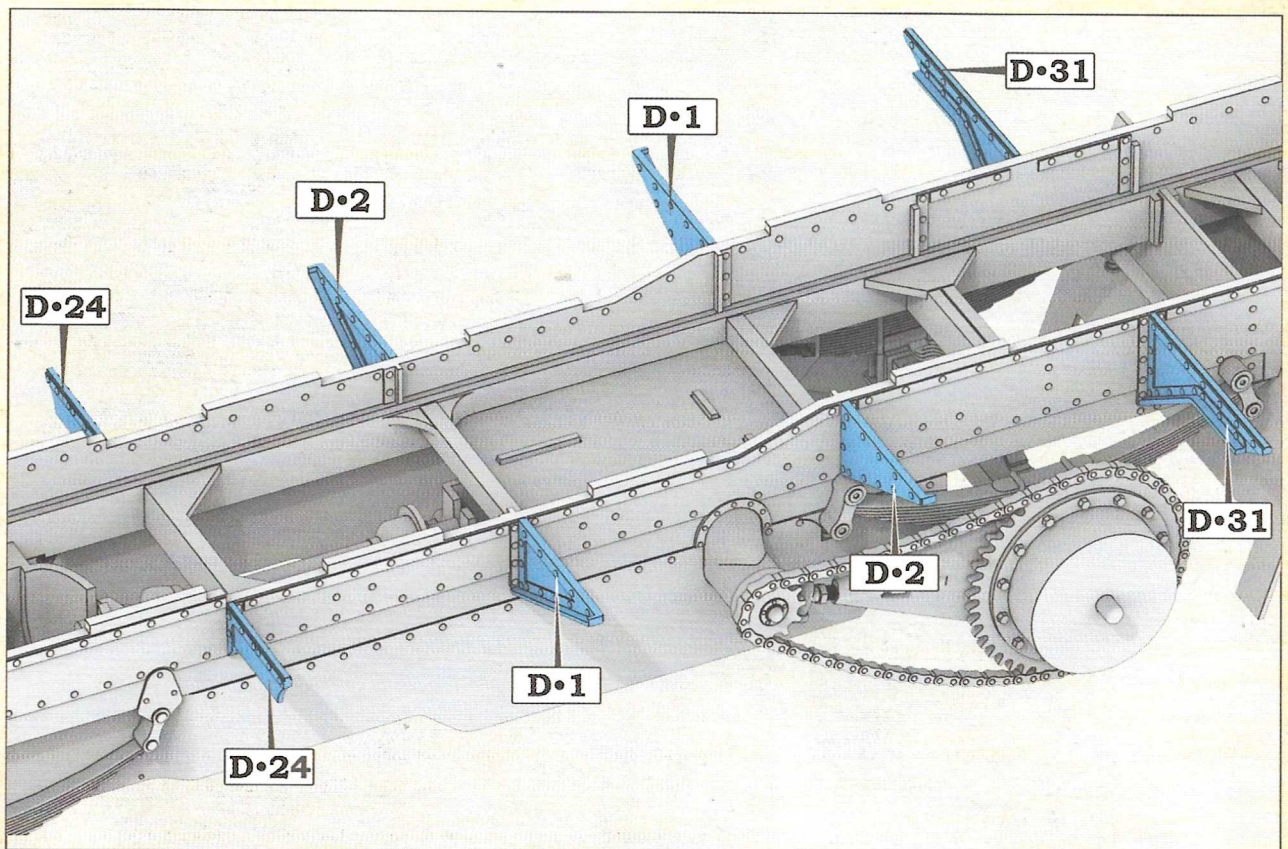

Step 20. Installation of the armoured body supports

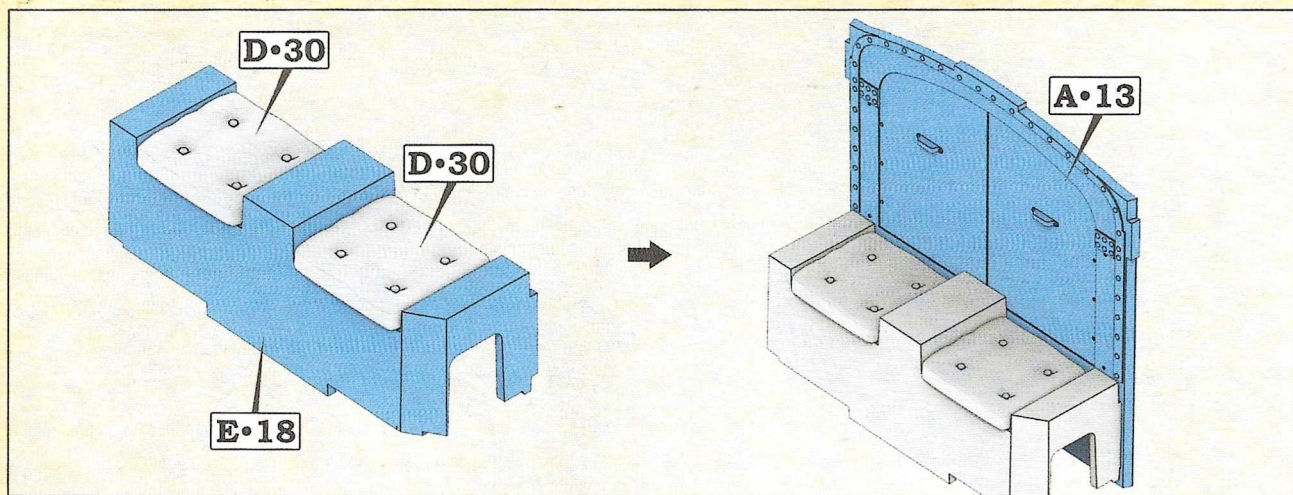

Step 21. Assembling the driver seats and the rear cab access door

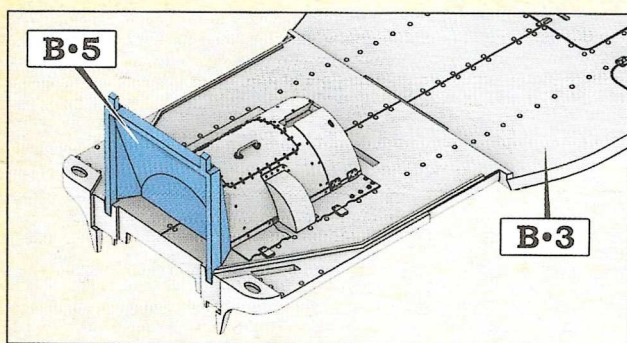

Step 22. Installation of the radiator rear cover

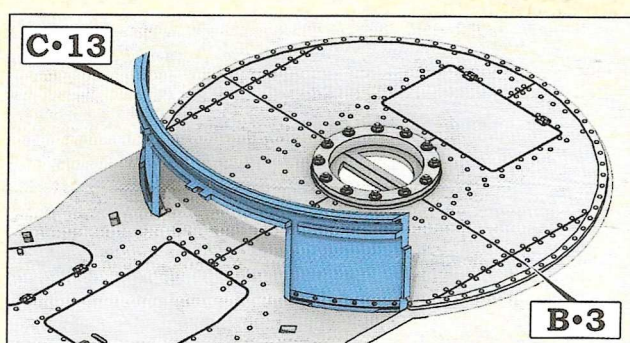

Step 23. Installation of main gun compartment's front wall

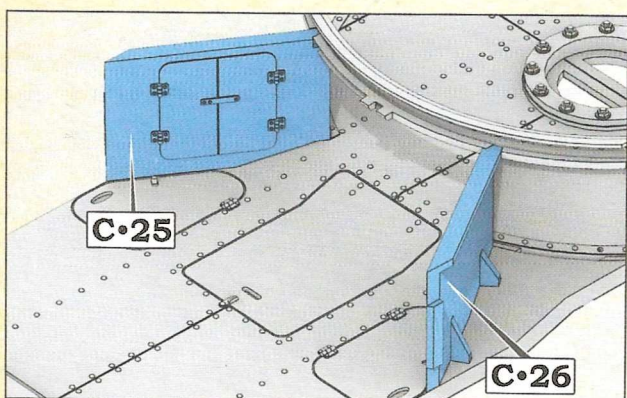

Step 24. Installation of the interior walls

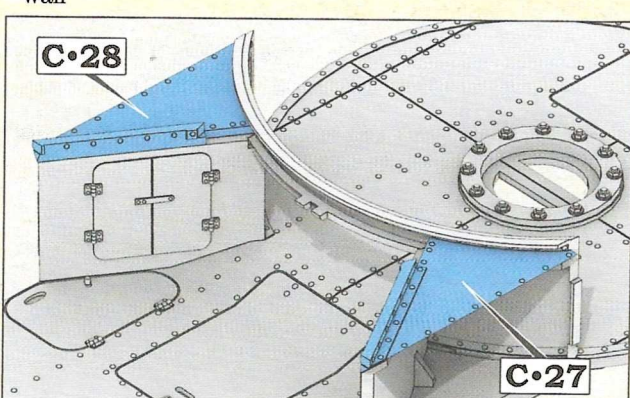

Step 25. Installation of the additional covers

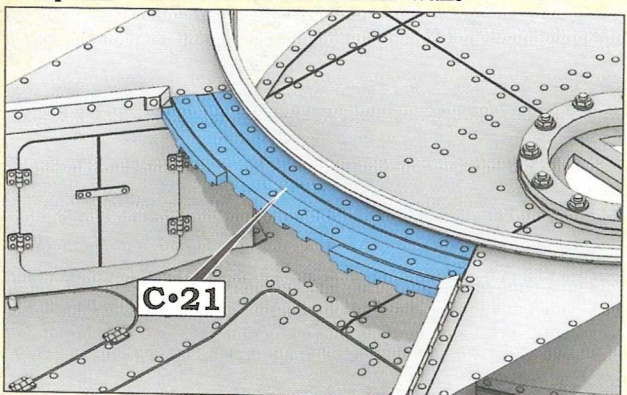

Step 26. Installation of the additional round section

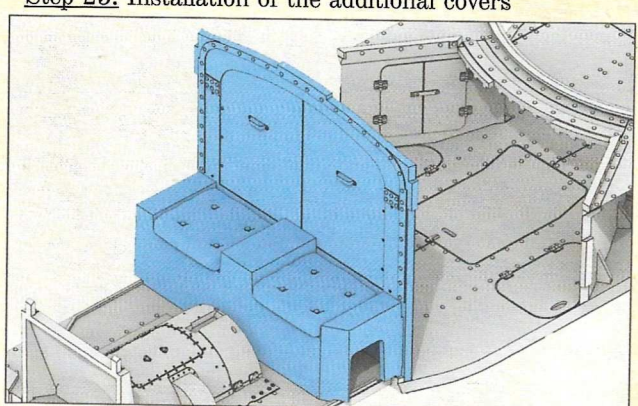

Step 27. Installation of the driver's seat and wall

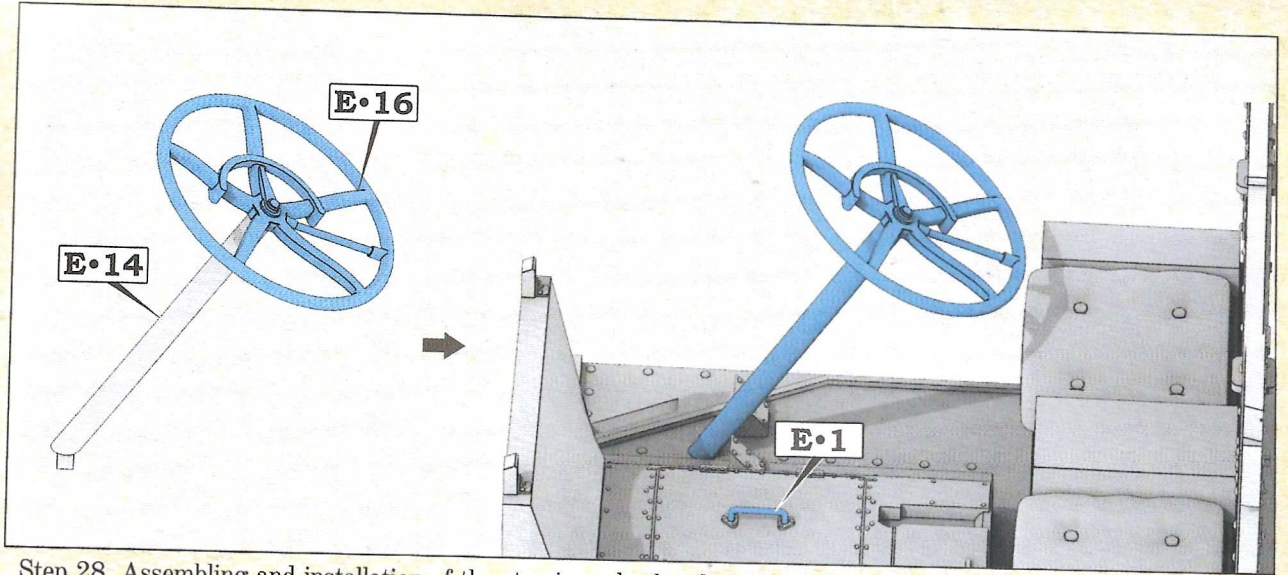

Step 28. Assembling and installation of the steering wheel and engine cover handle

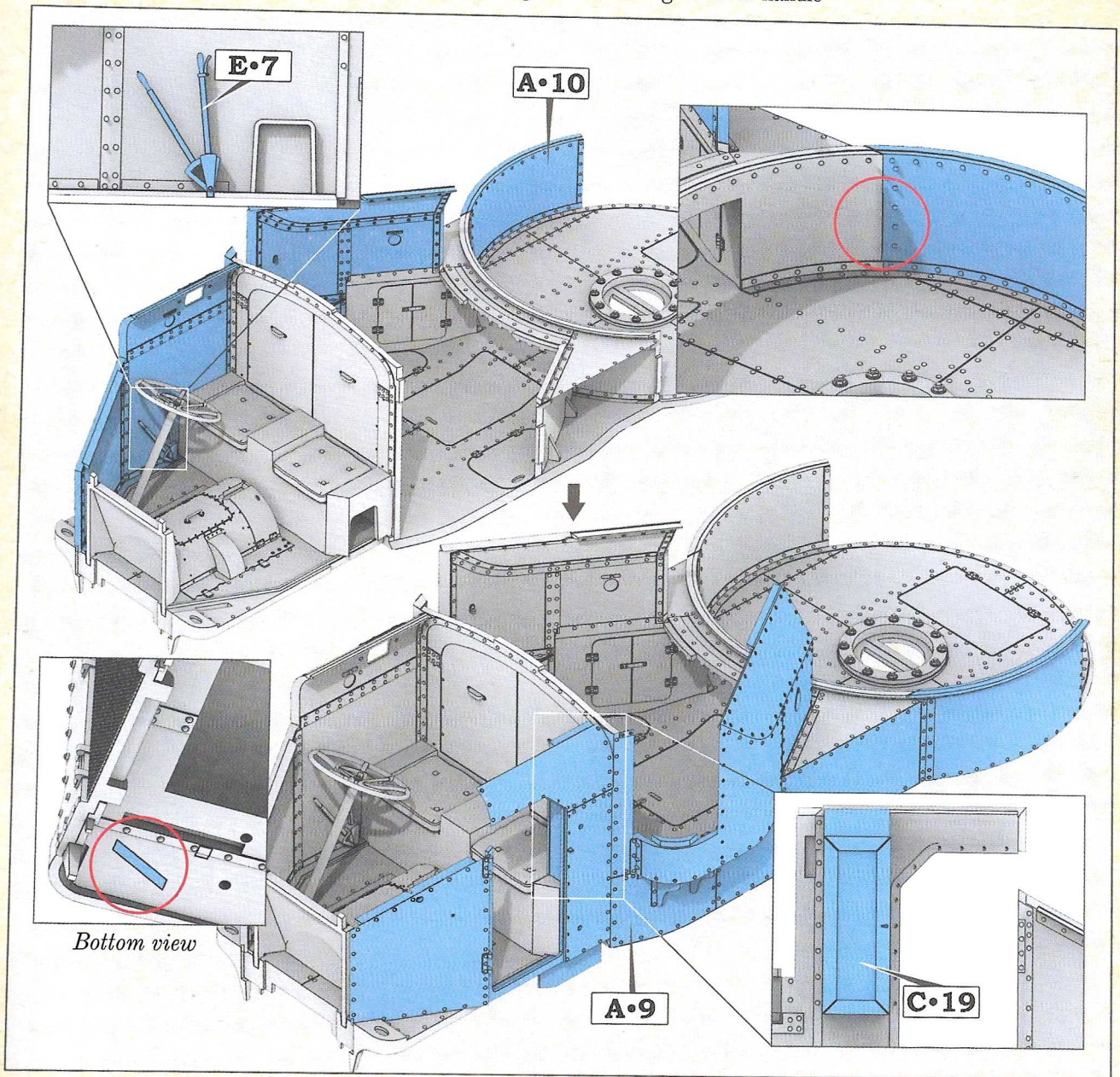

Step 29. Installation of the armoured superstructure walls

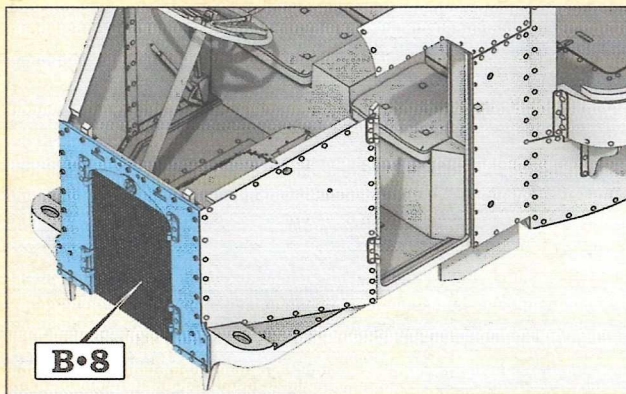

Step 30. Installation of the radiator front armoured wall

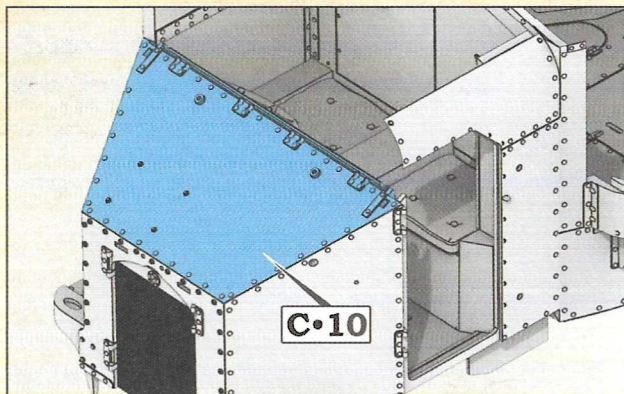

Step 31. Installation of the armoured hood

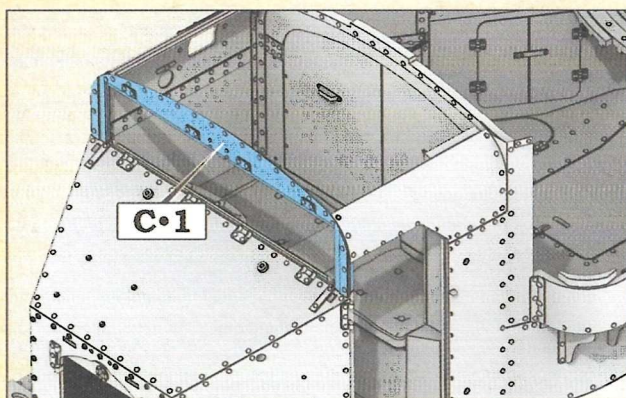

Step 32. Installation of the front driver's armoured plate at the front of the cab

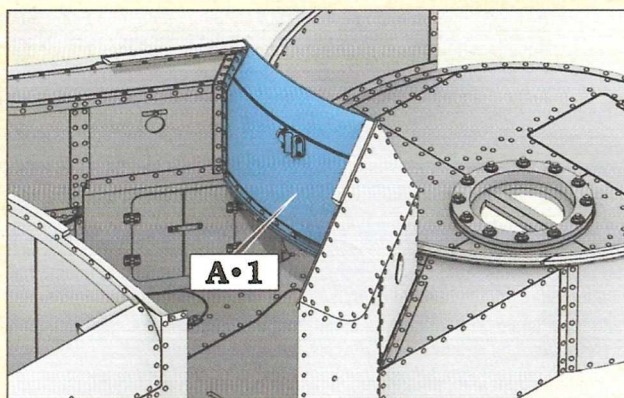

Step 33. Installation of the MG compartment rear wall

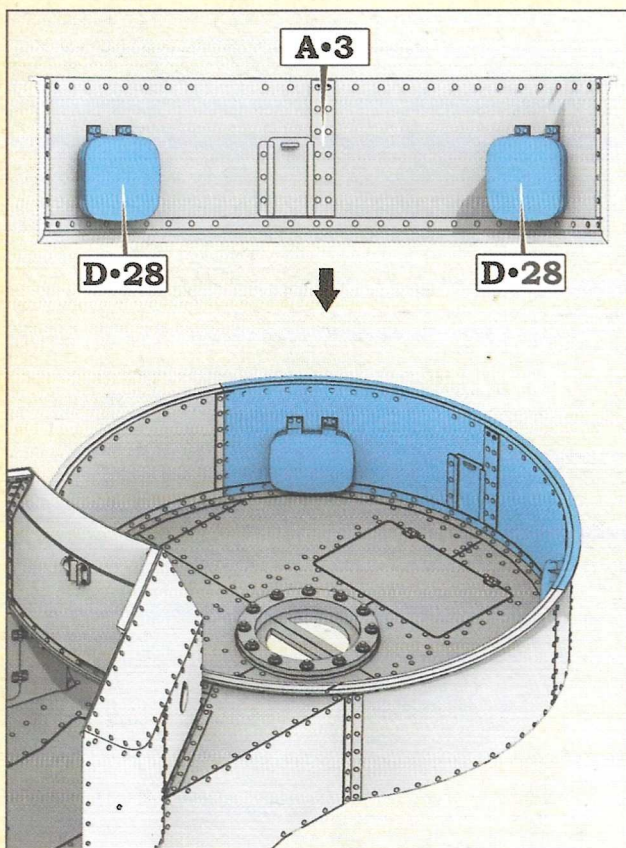

Step 34. Assembling and installation of the main gun compartment's rear wall

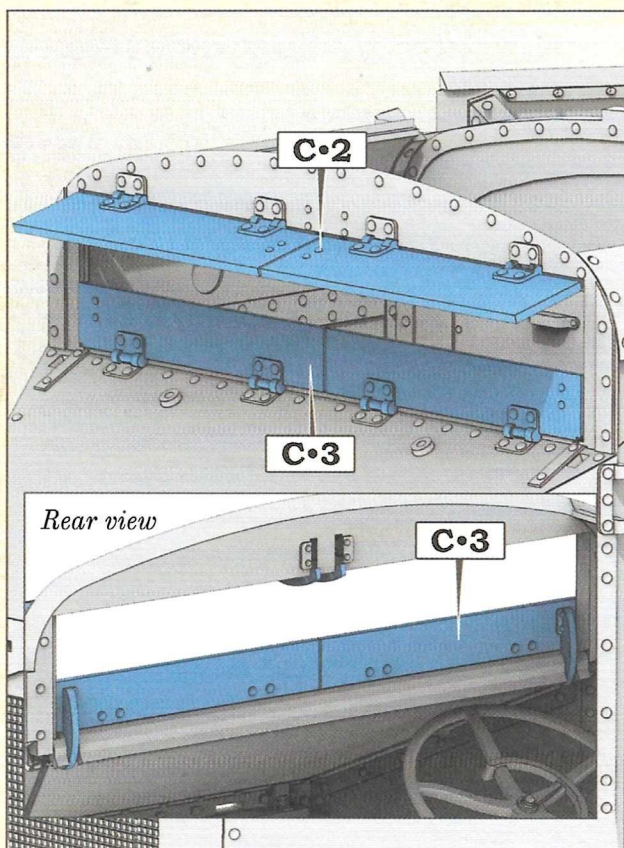

Step 35. Installation of the driver's shutters

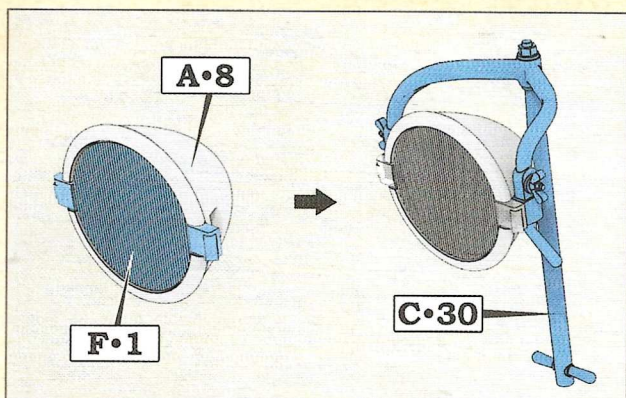

Step 36. Assembling the searchlight

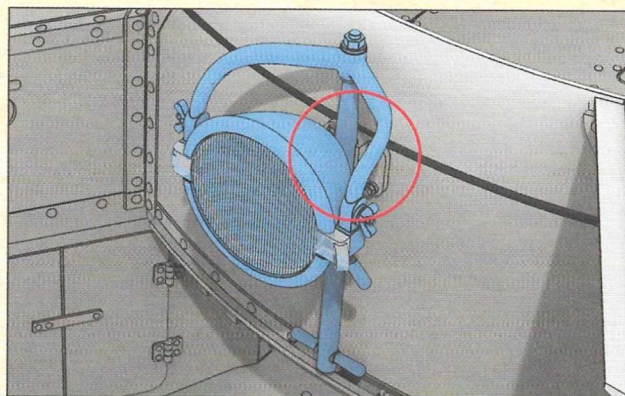

Step 37. Installation of the searchlight

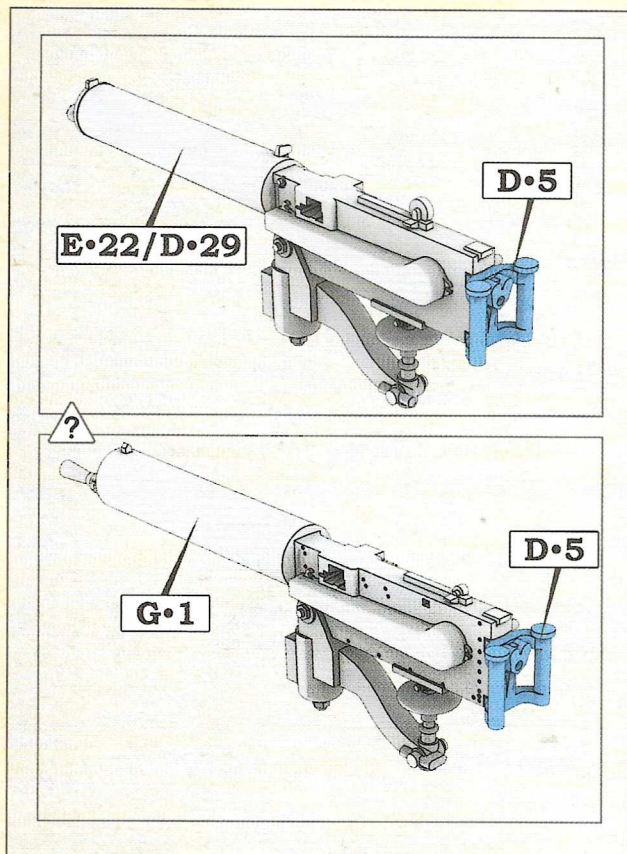

Step 38. Assembling the MG. Make 3. MG 08 (part G1) only for Freikorps version, kit number 350014

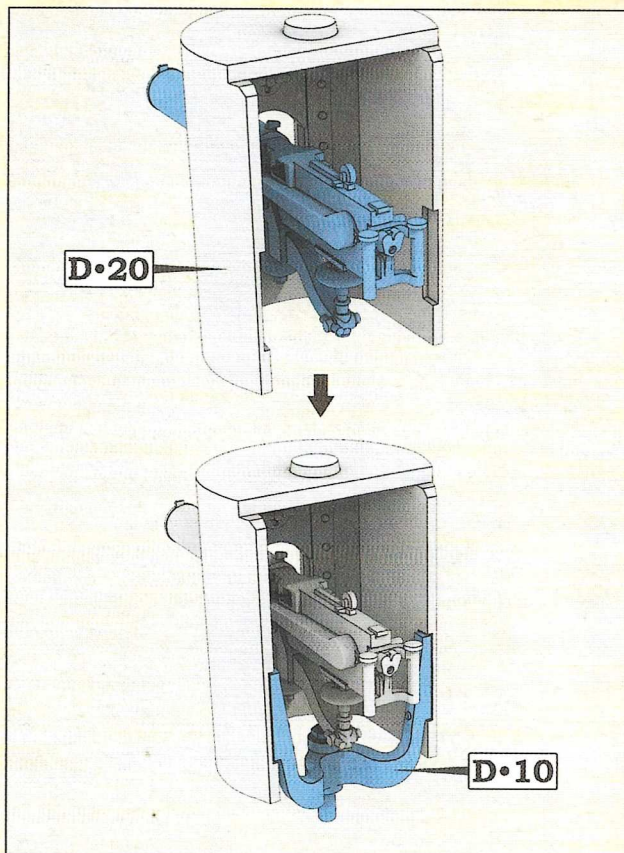

Step 39. Assembling the sponsons. Make two

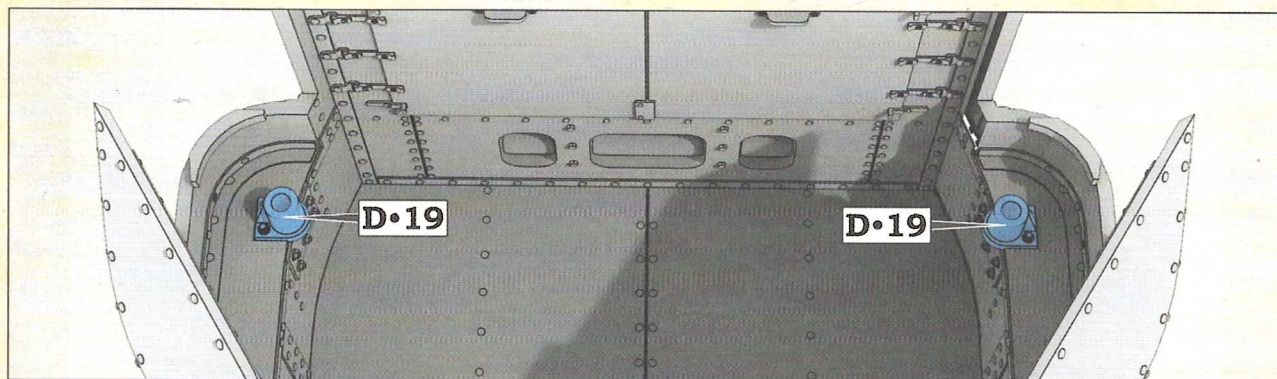

Step 40. Installing the sponsons' base plates

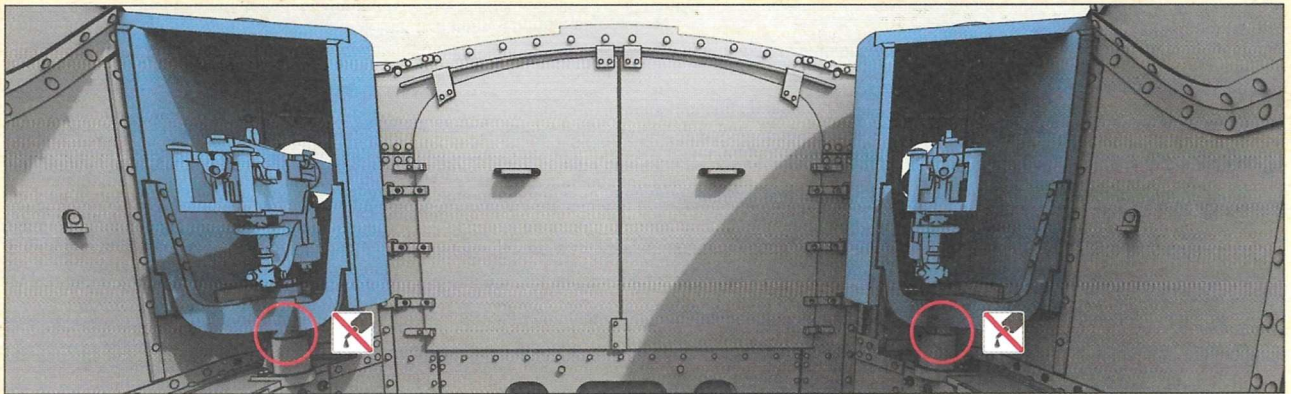

Step 41. Installing the sponsons. Do not use glue.

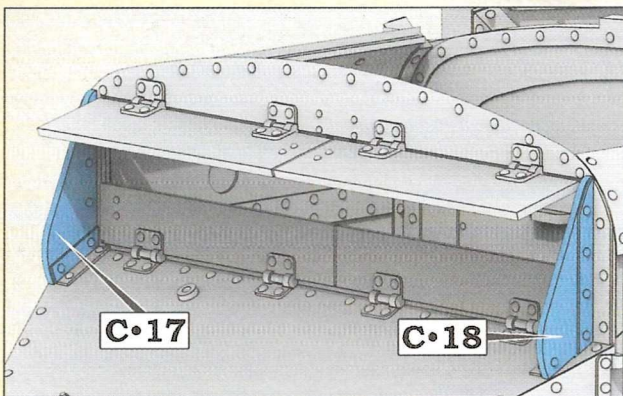

Step 42. Installing the driver side protective armoured plates

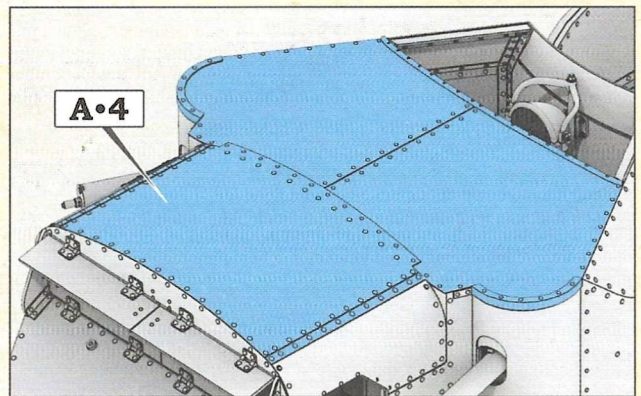

Step 43. Installation of the roof

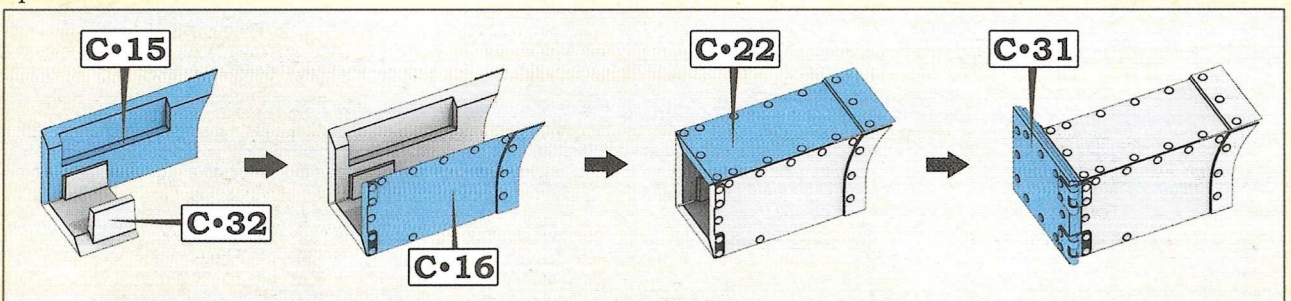

Step 44. Assembling the mirror reflector

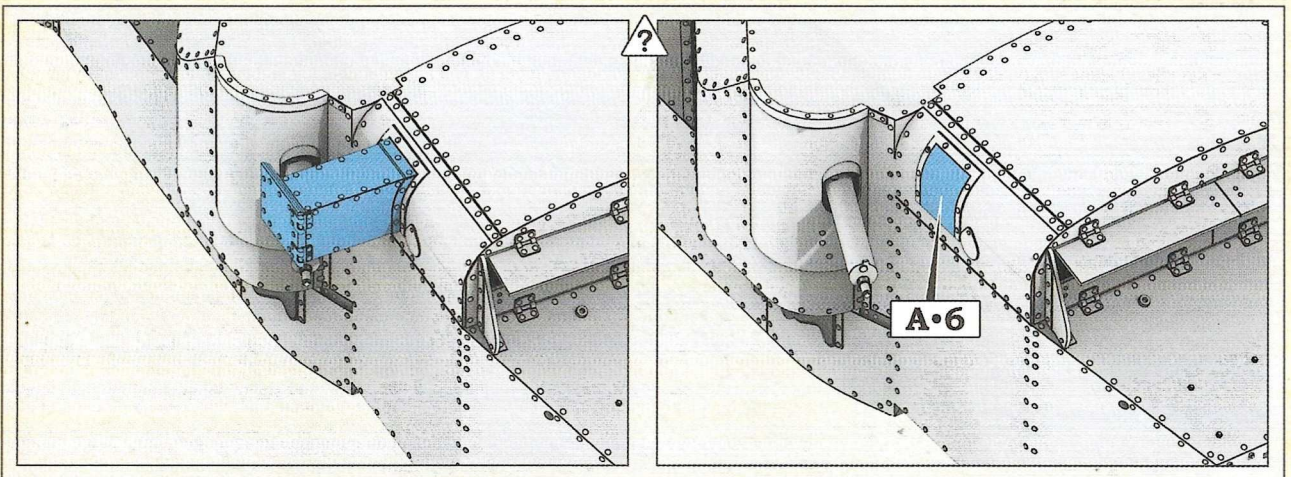

Step 45. Installation of the mirror reflector (for kit number 35009, 350015) or patch (only for Freikorps version, kit number 350014)

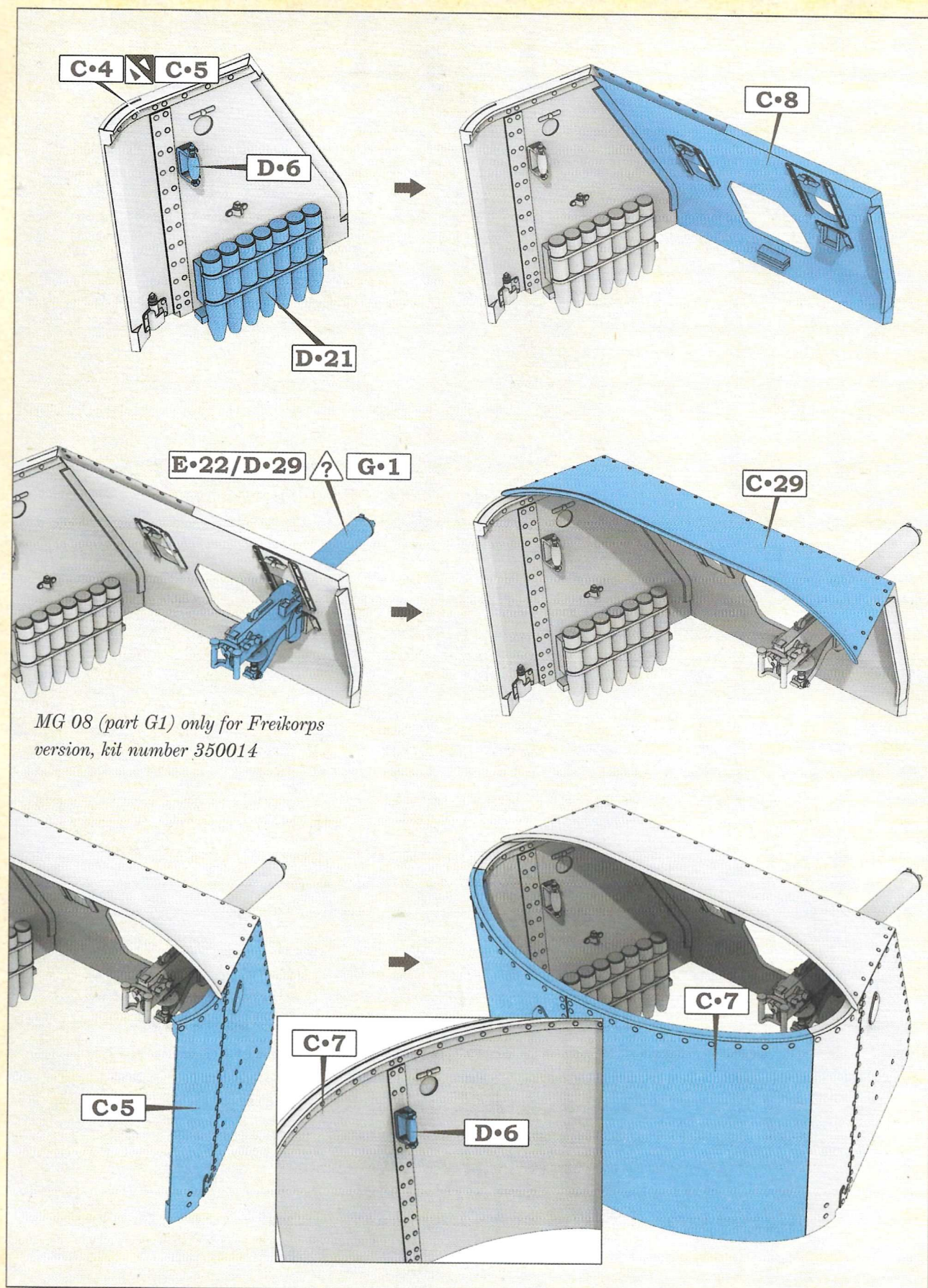

Step 46. Assembling the turret

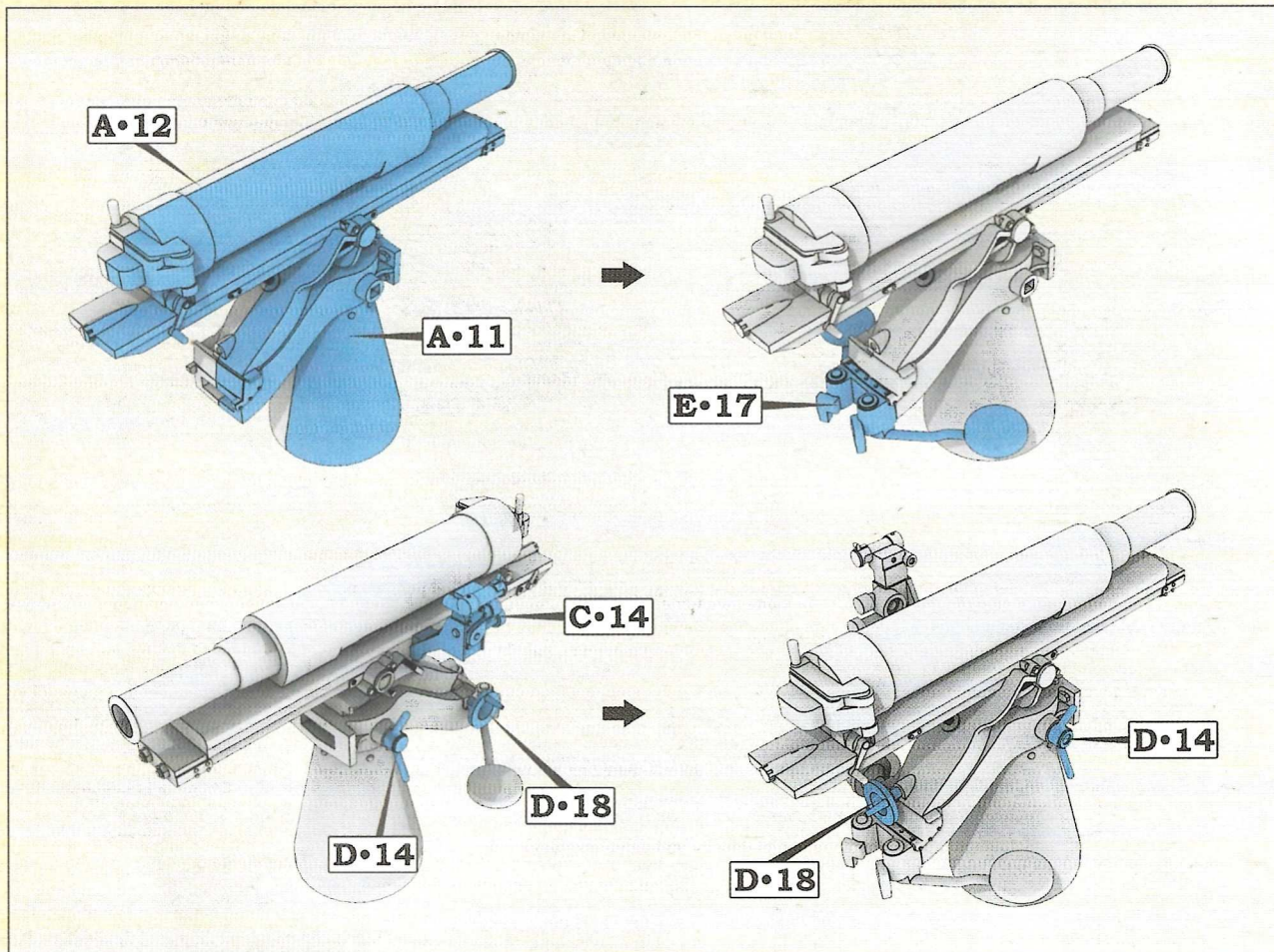

Step 47. Assembling the 76mm Model 1910 "anti-assault" gun

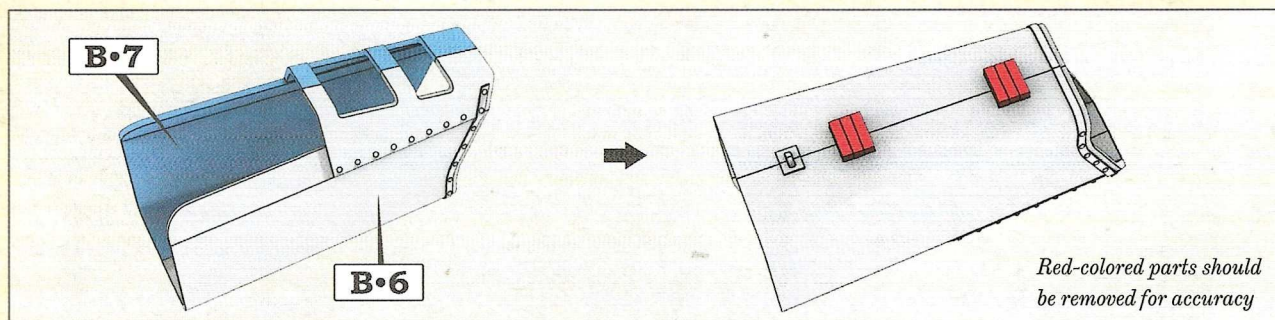

Step 48. Assembling the gun's armoured cowl

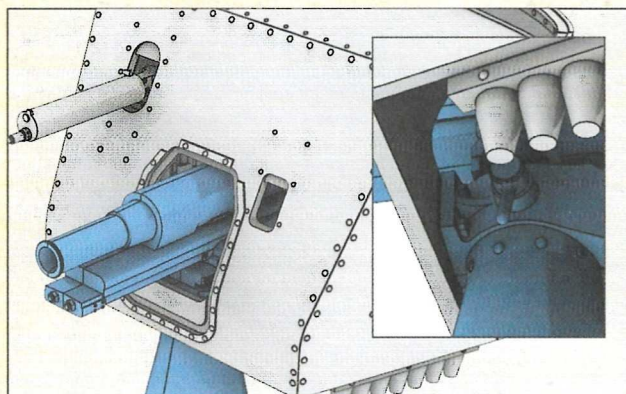

Step 49. Assembling the gun and the turret

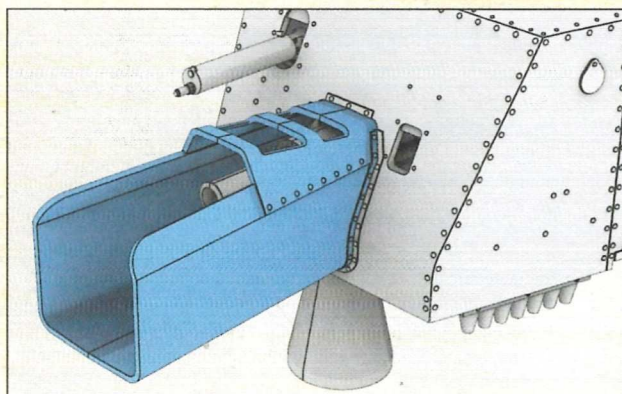

Step 50. Installation of the armoured cowl

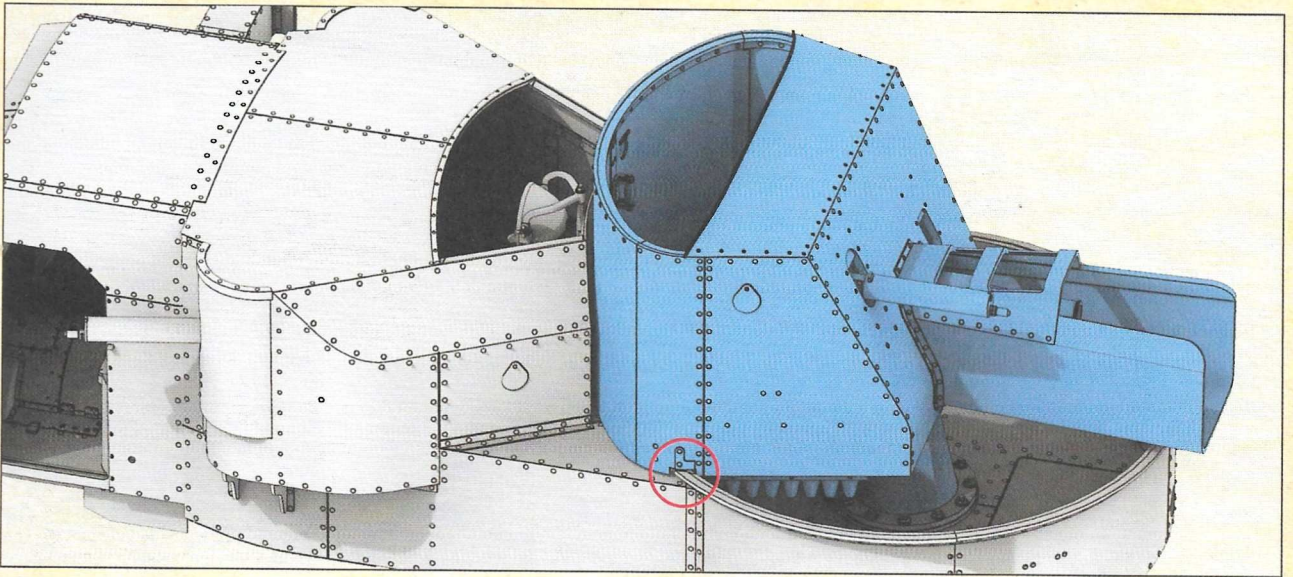

Step 51. Installing the gun assembly

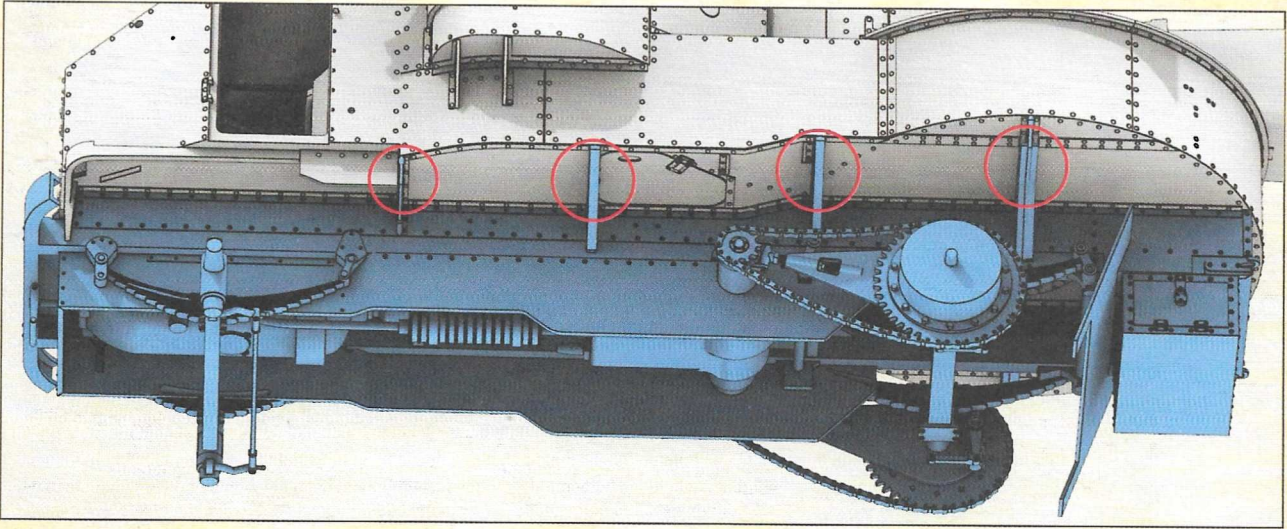

Step 52. Assembling the upper armored body on the chassis

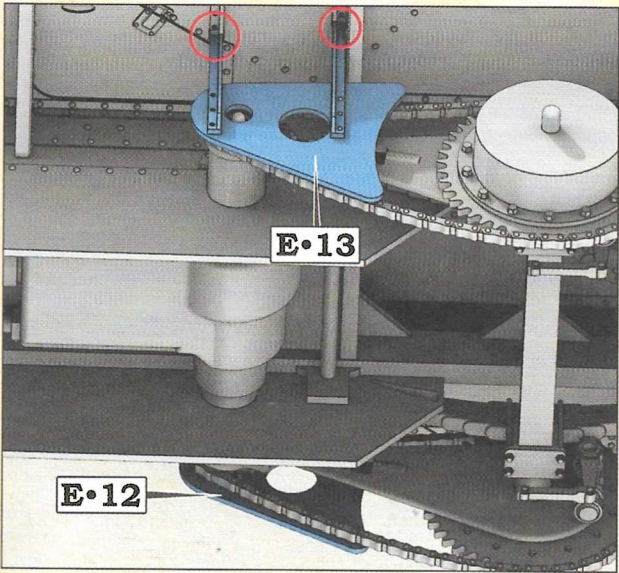

Step 53. Installation of the drive chain cover

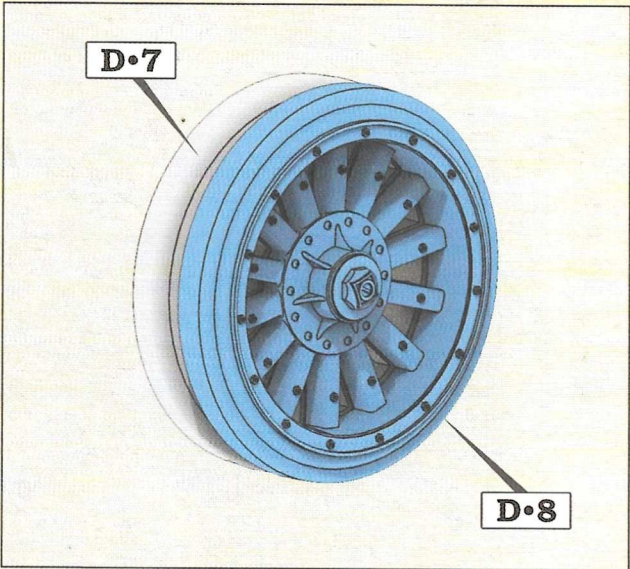

Step 54. Assembling the rear wheels. Make two

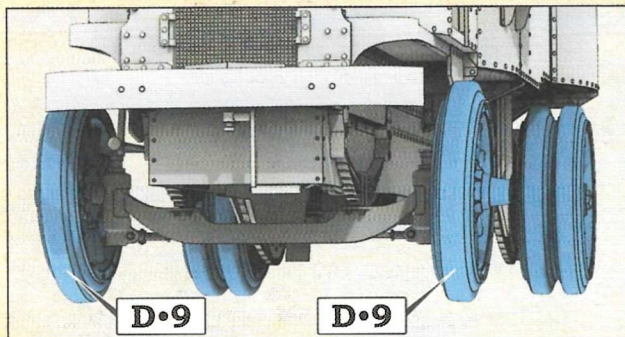

Step 55. Installing the wheels

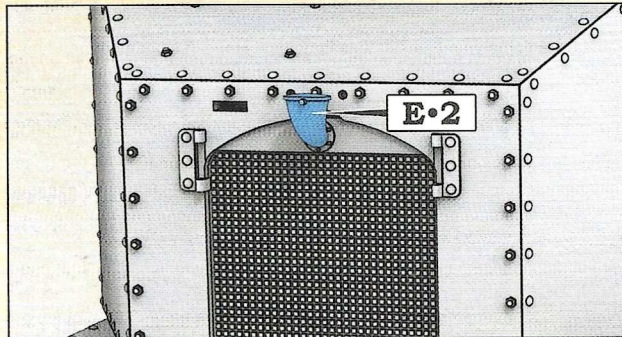

Step 56. Installation of the radiator filler neck

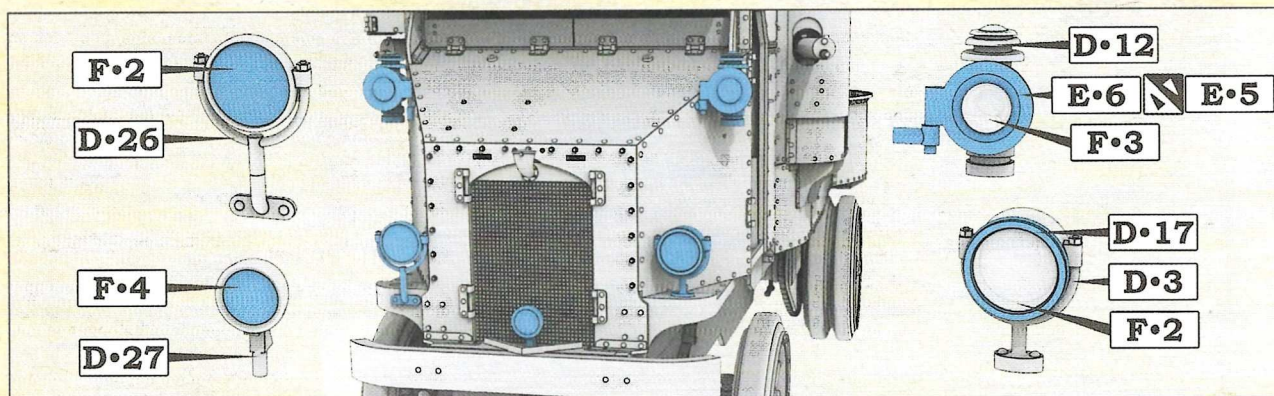

Step 57. Installing the headlamps. D26 only for Freikorps version (kit number 350014). Check picked markings

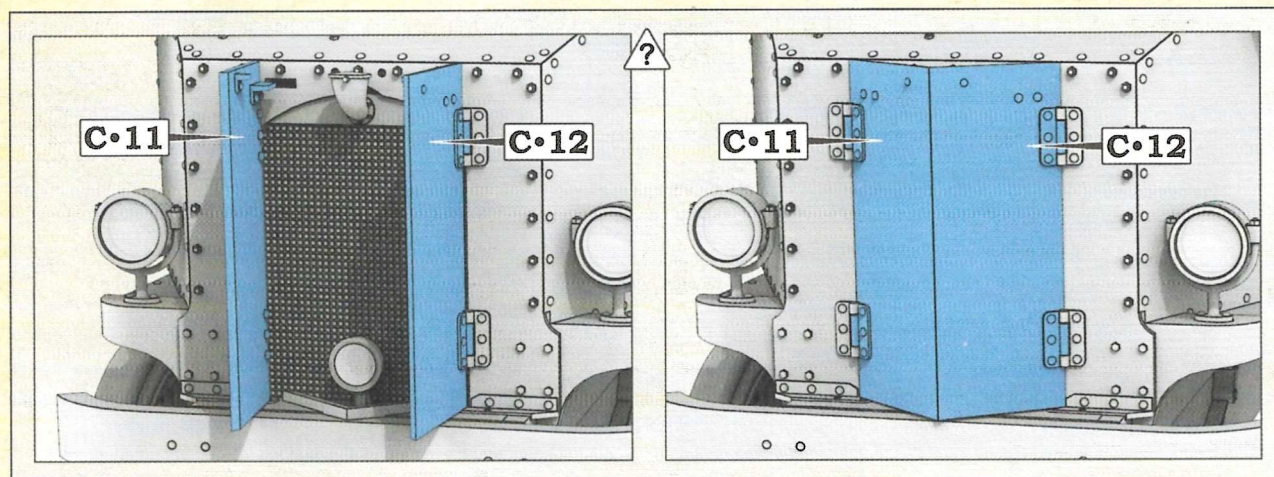

Step 58. Installation of the radiator shutters

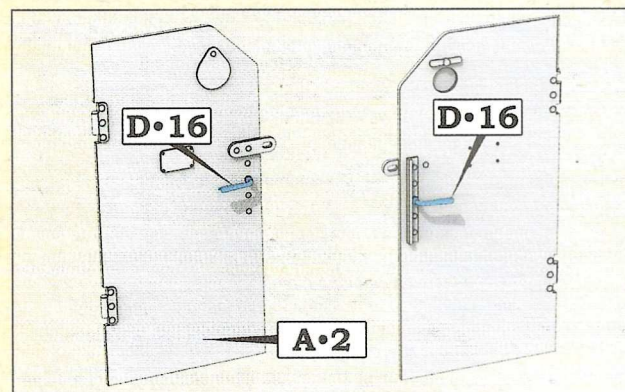

Step 59. Assembling the driver's door

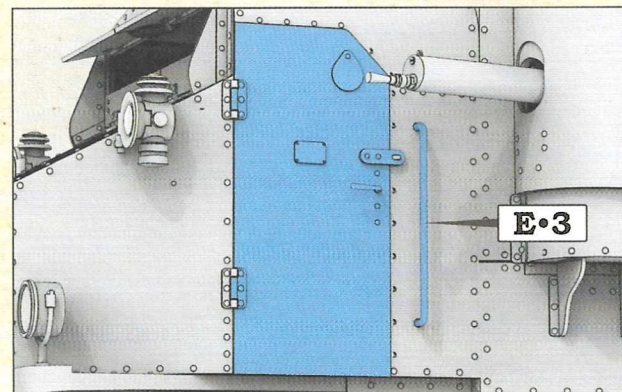

Step 60. Installing the door and the handle

CSM team would like to thank:

Stanislav Kiriletz - Germany

Brandon Darnell - USA

Tim Gosling - United Kingdom

for all your help in this project

CSM SIA
Cesvaines 4, LV-1073,
Riga, Latvia



Visit our website
www.copperstatemodels.com

2023